

PLAT OF SURVEY
-OF-

That part of the Southeast 1/4 of Section 5, Township 4 North, Range 18 East of the 4th Principal Meridian in the Township of East Troy, County of Walworth and State of Wisconsin, being more particularly described as follows: Commencing at the Southwest corner of the Southeast 1/4 of said Section 5; thence North 01°00'00" East along the West line of the Southeast 1/4 of said Section 5, 1207.56 feet to the place of beginning of this description; thence continue North 01°00'00" East along said East line 690.27 feet to a point on the South line of C.T.H. "J"; thence Northeasterly along said South line, being the arc of a curve whose radius point lies to the South having a radius of 5689.65 feet, a central angle of 00°52'55" whose long chord bears North 87°47'29" East 87.59 feet, a distance of 87.59 feet; thence North 88°14'00" East along said South line 743.20 feet to a point of curvature; thence Northeasterly along the arc of said Curve, also being the Southerly line of said Road whose radius point lies to the North, having a radius of 995.37 feet, a central angle of 01°52'26", whose long chord bears North 84°53'40" East 116.09 feet, a distance of 116.16 feet; thence South 00°05'59" West 458.02 feet; thence South 88°59'01" East 65.00 feet to a found concrete monument; thence South 00°05'59" West 217.80 feet to a found concrete monument; thence South 88°59'01" East 200.00 feet to a found concrete monument; thence South 00°05'59" West 33.20 feet; thence South 00°09'16" West 211.29 feet to a found iron pipe; thence South 00°47'02" West 243.46 feet to a found iron pipe; thence North 70°04'01" West 1295.49 feet to the place of beginning. Containing 22.23 acres of land more or less. Subject to the rights of the public for Oakwood Road.

Survey For: Atty. Lloyd Henry
Owner: Sawyer Estate

- — FOUND CONCRETE MONUMENT
- — FOUND IRON PIPE
- — SET IRON PIPE

SCALE: 1" = 200'

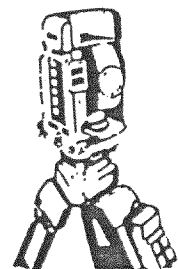

B.W. SURVEYING
Land Surveys
Mapping And Planning
35117 Academy Road
Burlington, Wisconsin 53105
(414) 534-4109

"I hereby certify that I have surveyed the above described property and that the above map is a true representation thereof and shows the size and location of the property, its exterior boundaries, the location of all visible structures and dimensions of all principal buildings thereon, boundary fences, apparent easements, roadways and encroachments, if any.

"This survey is made for the use of the present owners of the property, and those who purchase, mortgage, or guarantee the title thereto within one year from date hereof"

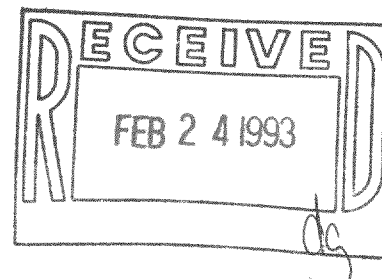
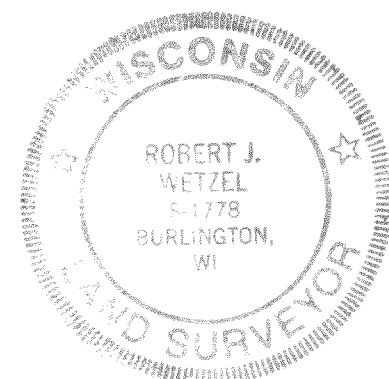

THIS IS NOT AN ORIGINAL PRINT
UNLESS THIS SEAL IS RED

Robert J. Wetzel
ROBERT J. WETZEL
REGISTERED LAND SURVEYOR - 1778

3/20/92
DATE

815
JOB NUMBER